

Ist Floor

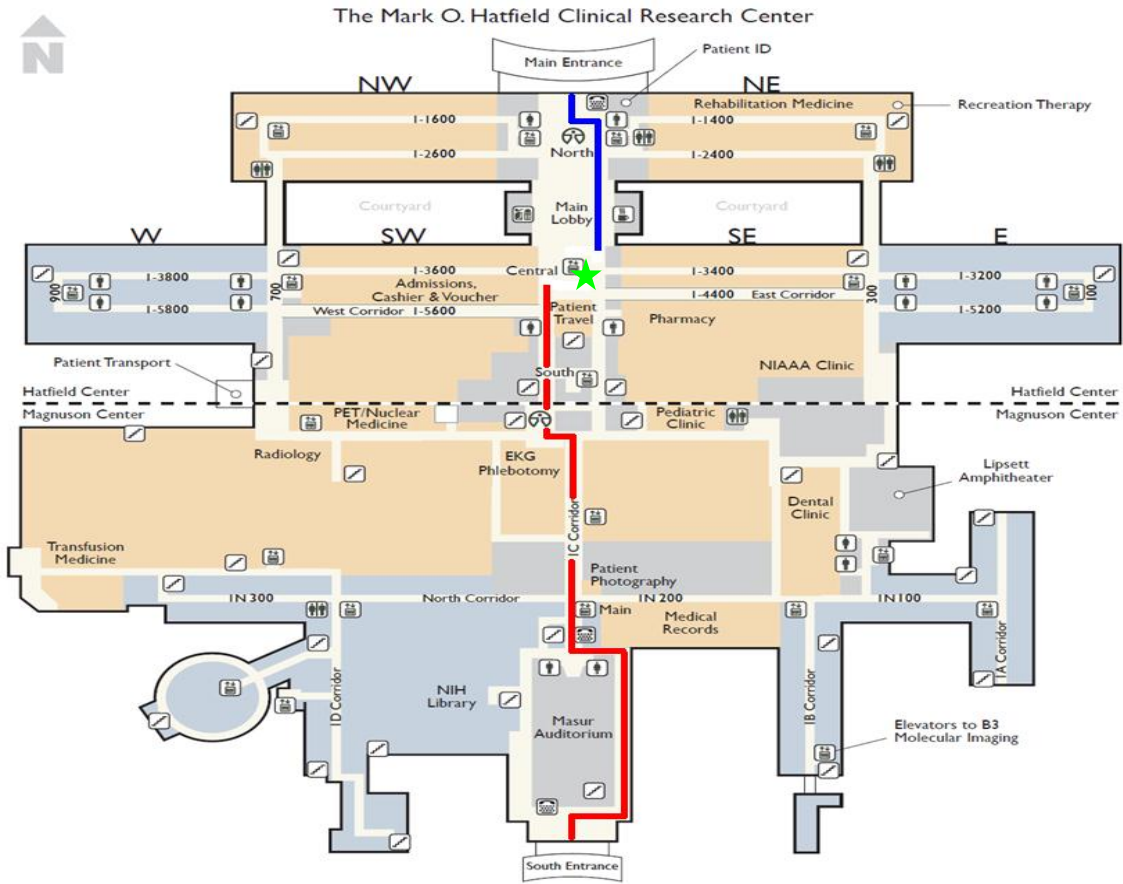

The Warren Grant Magnuson Clinical Center

- | | | | |
|--------------------|-------------------|-------------|---------------------------------------|
| Patient Areas | Restrooms | Hospitality | Floor Corridor Room I-5 200 NW |
| Research/Lab Areas | Stairs | TTY Phone | |
| | Elevators | Coffee Shop | |
| | Central Elevators | Gift Shop | |

— From the South Entrance of the Magnuson Clinical Center:
 Proceed right, at the top of the ramp/hallway, turn left, then make an immediate right.
 Proceed straight past the main elevators towards Phlebotomy and the Hatfield Clinical Research Center.
 Turn left just past Phlebotomy and make an immediate right (Hospitality desk on left).
 Continue straight into the Hatfield Clinical Research Center, passing Admissions (on your left).
 Across from admissions, take the central elevators to the 7th floor atrium area.

— From the Main (North) Entrance of the Hatfield Clinical Research Center:
 Proceed past the Hospitality desk through the atrium area to the central elevators (adjacent to Admissions/Patient Travel).
 Take the central elevators to the 7th floor atrium area.

For assistance, please contact the Hospital Epidemiology Service, 301-496-2209.